



STAINLESS STEEL MAINS PRESSURE

KEY FEATURES INCLUDE:

- Standard sizes 45-300 litres (see reverse)
- Available with outdoor/indoor options
- Mains, medium and low pressure options
- Custom made models up to 600 litres with outdoor option
- Lightweight, easy installation
- Future-proofed
- Duplex stainless steel barrel to withstand high temperatures without damage to the cylinder
- Pumped coil for Solar, Heat Pump and Radiator-Boiler systems
- Wetback coil for thermosiphon systems
- Twin coil models include pumped and wetback coils
- Double element option for quick heat recovery
- Left and right connections
- Low power usage through high density insulation
- Foamed with new generation HFC, non-ozone depleting polyurethane
- Suitable for a wide range of water conditions
- Low maintenance

**OUR DESIGN AND MANUFACTURING PROCESSES
PROVIDE YOU WITH THE BEST CHOICE FOR FUTURE-
PROOFED HOT WATER CYLINDERS.**

**YOU CAN RELY ON PETER COCKS FOR DURABILITY
AND EFFICIENCY.**



*Warranty applies to all Peter Cocks Standard stainless steel cylinders manufactured after 1 October 2017



114 Maces Rd • Christchurch 8062 • New Zealand

P: (03) 384 1360 • 0800 555 048 • F: (03) 384 5903 • info@petercocks.co.nz

www.petercocks.co.nz •  Peter Cocks Hot Water Cylinders



**100%
NZ DESIGNED & ASSEMBLED**

THINK PETER COCKS FOR ALL YOUR WATER HEATING NEEDS

SUPERIOR QUALITY

Peter Cocks stainless steel mains pressure cylinders are manufactured to meet New Zealand standards.

COMPATIBILITY

Models to suit most systems including direct connections for solar and heat pump, pumped coil (M1 & M3) for closed loop solar or heat pump and wetback coil (M2) for thermosiphon systems.

ALL PRESSURE

Supplied as a choice of low, medium or high pressure units. Peter Cocks hot water cylinder maximum inlet pressure is 500kPa.

SOLAR EFFICIENCY

Peter Cocks hot water cylinders can be specified with connections for both open and closed circuit solar heating enabling your household to reduce energy consumption.

EASY INSTALLATION

Peter Cocks hot water cylinders are lightweight, easy to install and are manufactured to all relevant building codes. When installed correctly, they comply with the requirements of the New Zealand building code, G12/AS1 and NZ standards.

All cylinders supplied with 10kW TPR Valve 850kPa, except Coil models supplied with 46kW TPR Valve 850kPa

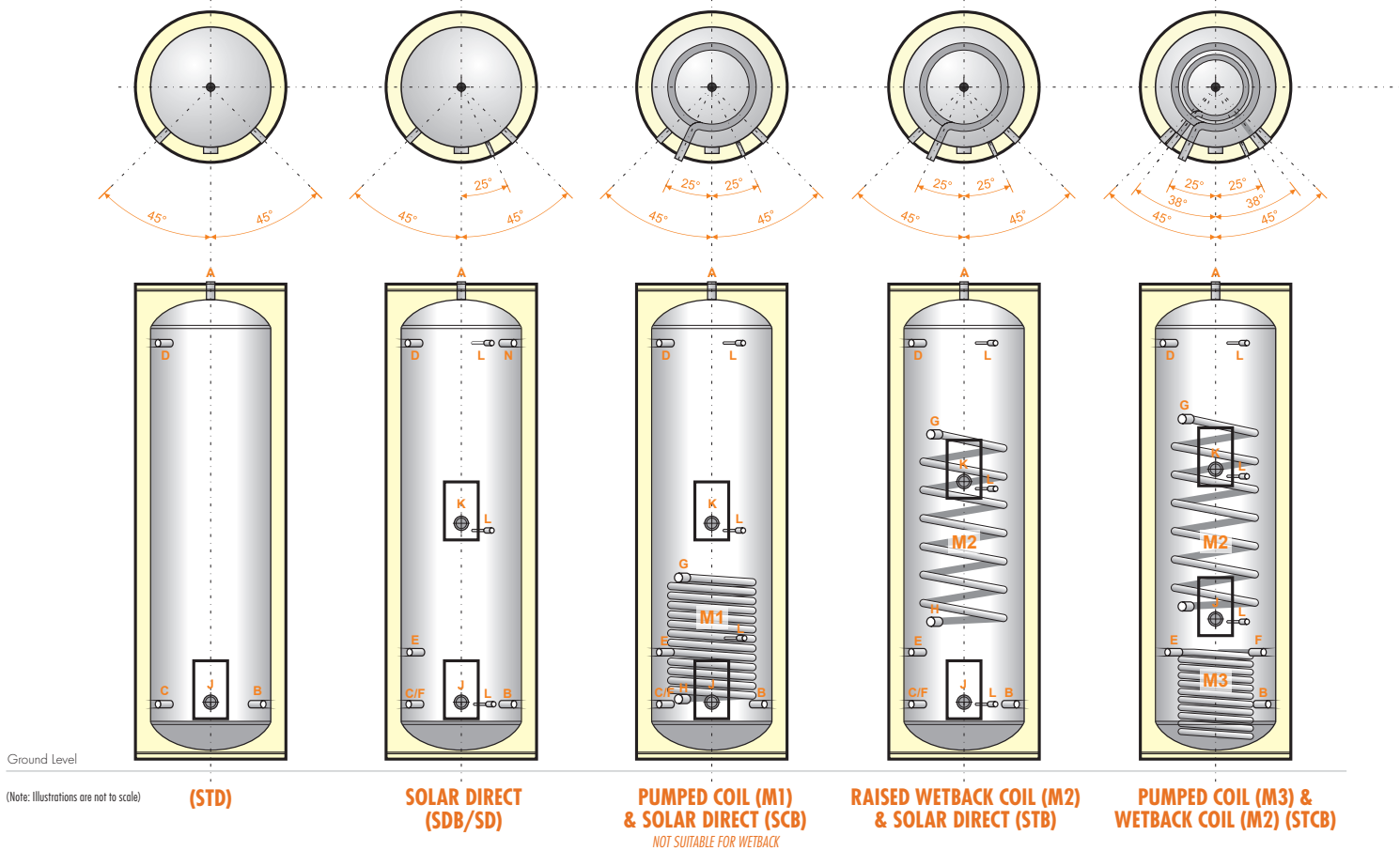

| FEATURES | | STD | | | | STD/SDB/SD | | | | | SCB^ | | STB^ | | STCB | |
|---|-----------------------|-----|-----|--------|------|------------|------|-------|------|------|------|------|------|------|------|------|
| DESCRIPTION | CONNECTION | 45L | 90L | 135L^^ | 135L | 180L | 180L | 200L* | 250L | 300L | 250L | 300L | 250L | 300L | 250L | 300L |
| CYLINDER DIAMETER | | 485 | 485 | 488 | 560 | 488 | 560 | 560 | 560 | 560 | 560 | 560 | 560 | 560 | 560 | 560 |
| A Hot Water Draw-Off (Cylinder Height) | 3/4" BSP F | 530 | 940 | 1350 | 1010 | 1760 | 1295 | 1425 | 1730 | 2045 | 1725 | 2045 | 1725 | 2045 | 1725 | 2045 |
| B Right Cold Feed (High Pressure) Inlet | 3/4" BSP F | N/A | N/A | 185 | 195 | 185 | 195 | 195 | 185 | 185 | 200 | 200 | 200 | 200 | 200 | 200 |
| C Left Cold Feed (High Pressure) | 3/4" BSP F | 165 | 165 | N/A | 195 | 185 | 195 | 195 | 185 | 185 | 200 | 200 | 200 | 200 | - | - |
| D Safety TPR | 3/4" BSP F | TOP | 720 | 1165 | 790 | 1560 | 1075 | 1205 | 1510 | 1825 | 1500 | 1810 | 1500 | 1810 | 1500 | 1810 |
| E From Solar (Inlet) / HP Return Kit set - excludes STD Model | 3/4" BSP F | - | - | - | - | 360 | 370 | 370 | 360 | 360 | 370 | 370 | 370 | 370 | 370 | 370 |
| F To Solar (Outlet) | 3/4" BSP F | - | - | - | - | 185 | 195 | 195 | 185 | 185 | 200 | 200 | 200 | 200 | 370 | 370 |
| G Secondary Solar/Wetback Flow (Coil) | 3/4" BSP F & 1" BSP M | - | - | - | - | - | - | - | - | - | 685 | 685 | 1285 | 1285 | 1340 | 1340 |
| H Secondary Solar/Wetback Return (Coil) | 3/4" BSP F & 1" BSP M | - | - | - | - | - | - | - | - | - | 245 | 245 | 485 | 485 | 540 | 540 |
| J Lower Element | 1 1/4" BSP F | ✓ | ✓ | ✓ | ✓ | ✓ | ✓ | ✓ | ✓ | ✓ | ✓ | ✓ | ✓ | ✓ | ✓ | ✓ |
| K Upper Element (SDB/SD) - excludes STD/SD | 1 1/4" BSP F | - | - | - | - | - | - | - | ✓ | ✓ | ✓ | ✓ | ✓ | ✓ | ✓ | ✓ |
| L Sensor Probe Pocket - excludes STD and 180SD | Ø8.5mm x 120mm Tube | - | - | - | - | - | - | ✓ | ✓ | ✓ | ✓ | ✓ | ✓ | ✓ | ✓ | ✓ |
| M1 Pumped Coil** | 10m Coil | - | - | - | - | - | - | - | - | - | ✓ | ✓ | - | - | - | - |
| M2 Wetback Thermosiphon Coil*** | 7.6m Coil | - | - | - | - | - | - | - | - | - | - | - | ✓ | ✓ | ✓ | ✓ |
| M3 Pumped Coil** | 10m Coil | - | - | - | - | - | - | - | - | - | - | - | - | - | ✓ | ✓ |
| N Extra R/H Outlet or TPR on SD/SDB (excludes 200L) | | - | - | - | - | - | ✓ | - | ✓ | ✓ | - | - | - | - | - | - |

F - Female M - Male Note: upper element supplied plugged. Element & T/Stat sold as an optional extra. Fitting heights measured from bottom of cylinder (in mm). All measurements are nominal.

*Available in SD models only **Compressed solar coils require a pumped based system ***Wetback Coil max input 3.5kW.

All Coil max flow rate 20L/min.

CUSTOM MADE CYLINDERS, NEW SIZES NOW AVAILABLE

430MM DIAMETER, 485MM DIAMETER, 540MM DIAMETER, 560MM DIAMETER, 575MM DIAMETER, 670MM DIAMETER, 690MM DIAMETER, 800MM DIAMETER

PLEASE SEE OUR WEBSITE OR YOUR LOCAL MERCHANT FOR AN ORDER FORM

- For full warranty conditions please visit www.petercocks.co.nz

- All information is current at the time of publication (June 2022) but may change without notice. Please check the specifications are current at the time of ordering or building to incorporate the appliance see www.petercocks.co.nz

- All cylinders installed as part of a new build must have a safe tray fitted (sold separately)

114 Maces Rd • Christchurch 8062 • New Zealand
P: (03) 384 1360 • 0800 555 048 • F: (03) 384 5903
E: info@petercocks.co.nz • www.petercocks.co.nz

